

Docket #4

Case No. CD-CPC-2020-00137

The Levy at Martini Corner

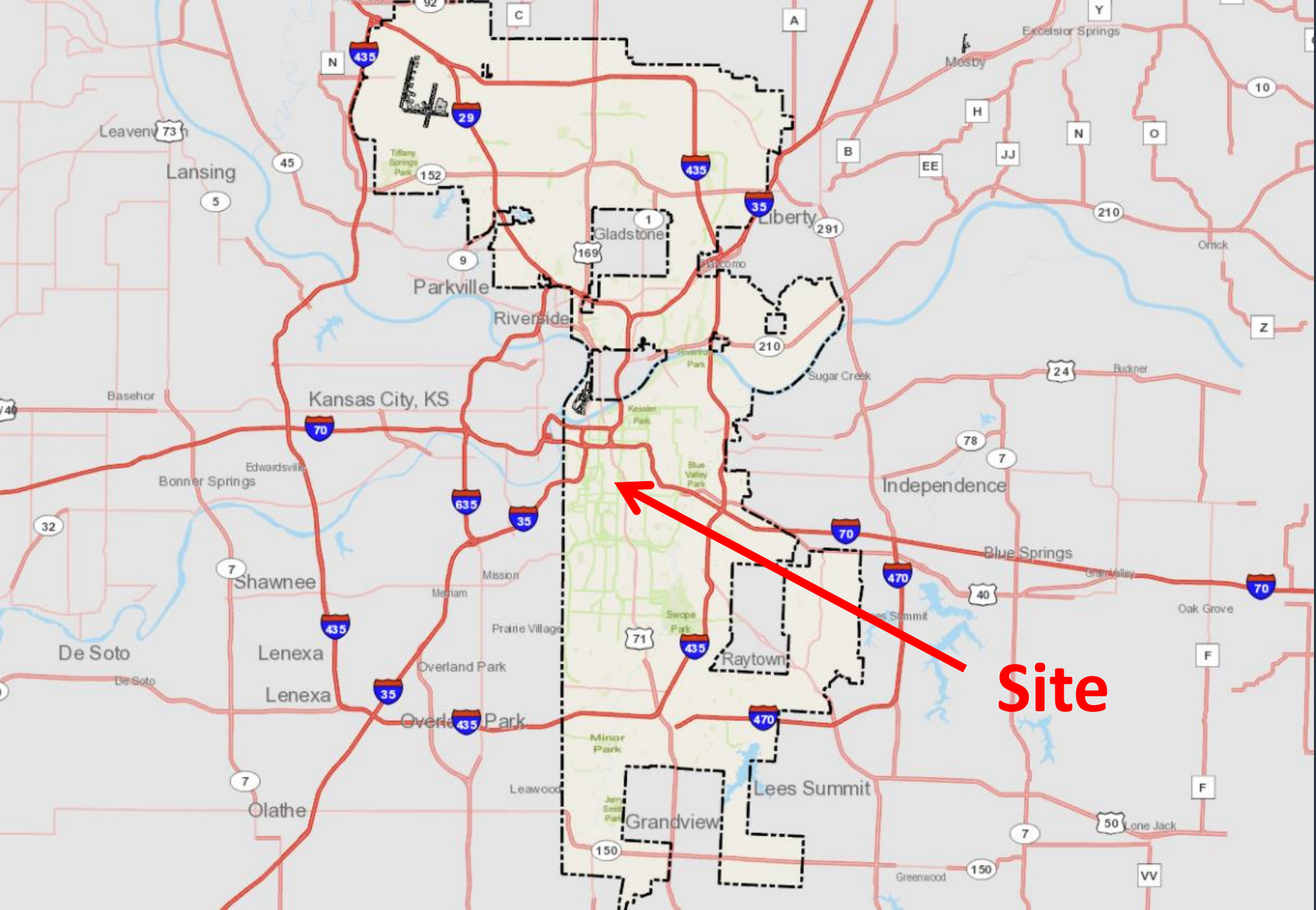

Site



Case No. CD-CPC-2020-00137





View looking north on Gillham Rd at 31st St



View looking north at front of building

 Case No. CD-CPC-2020-00137

Project Overview

- Applicant is proposing to rezone from M1-5 to UR which will serve as a development plan
- PIEA tax abatement
- New structure with 163 multi-family units with amenity space and a restaurant
- No waivers or deviations are requested

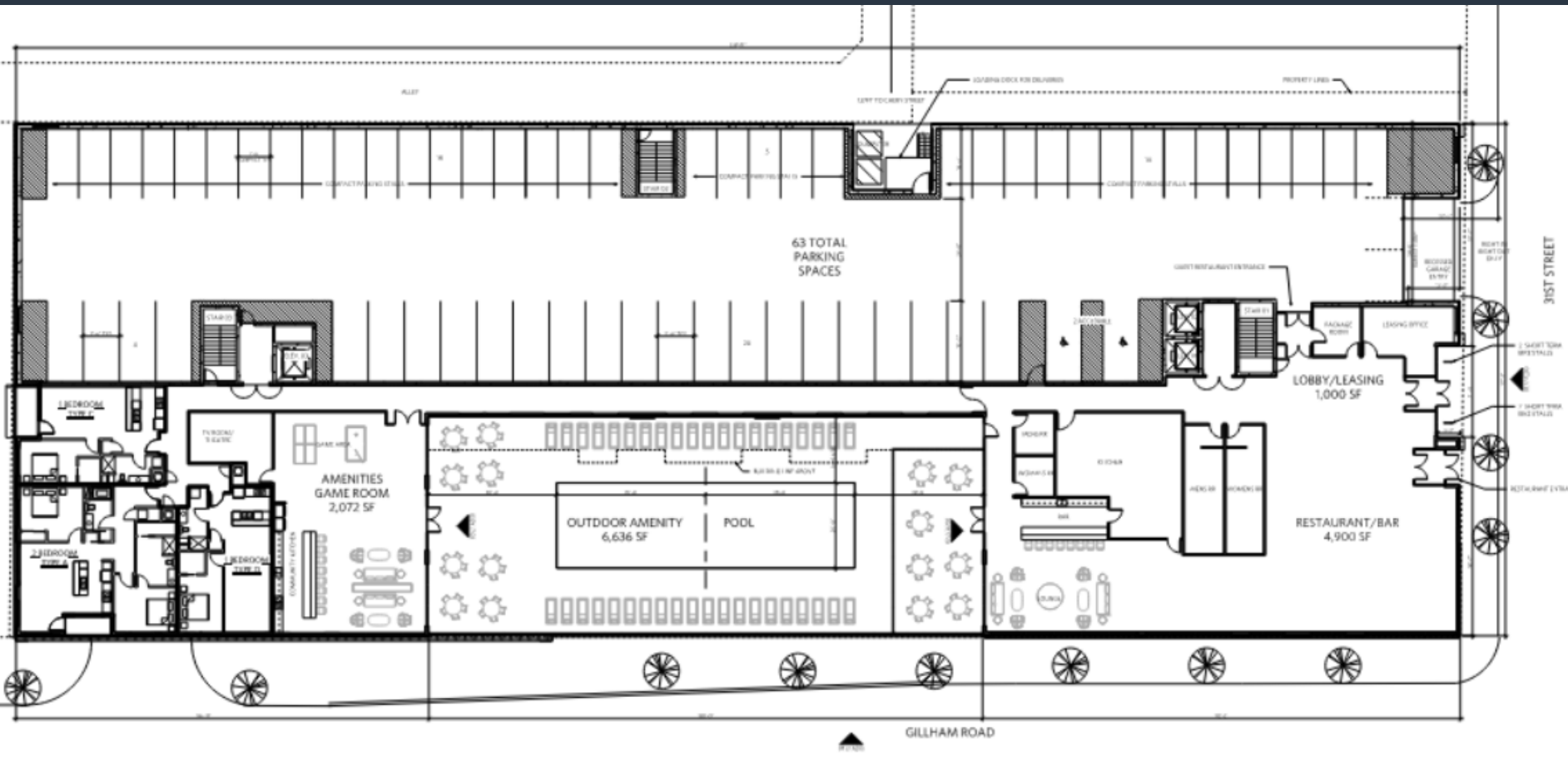



EAST 31st STREET

West Elevation



North & South Courtyard

South Elevation

East Elevation



North Elevation



Northwest Corner

Southwest Corner

Staff Recommendations:

Case No. CD-CPC-2020-00137

Approval subject to 34 conditions

