

LEGEND

- - MONUMENT FOUND AS NOTED
- - SET MONUMENT AS NOTED
- - FOUND 1/2" IRON BAR AT CORNER UNLESS OTHERWISE NOTED
- - SET 1/2" IRON BAR AT CORNER W/ J & J CAP
- (M) - MEASURED DISTANCE
- (R) - RECORD DISTANCE
- C/L - CENTER LINE
- R/W - RIGHT-OF-WAY
- - POWER POLE
- ⊙ - LIGHT POLE
- ⊙ - GUY WIRE
- - BOLLARD
- - WOOD FENCE
- - WROUGHT IRON FENCE

CLIENT:
 Kimley - Horn
 Patrick Joyce
 patrick.joyce@kimley-horn.com

PROPERTY ADDRESS:
 3825 Wyoming Street
 Kansas City, MO 64111

DEED DESCRIPTION:
 TRACT I:
 Lots 7, 8, 9 and 10, BLOCK 4, BONFILS HEIGHTS, a subdivision in Kansas City, Jackson County, Missouri

TRACT II:
 Lot 6, EXCEPT the North 42.3 feet hereof, measured at right angles to the North line, BLOCK 4, BONFILS HEIGHTS, a subdivision in Kansas City, Jackson County, Missouri.

NOTES:
 1.) The Plat of BONFILS HEIGHTS - BLOCK 4 is recorded in Plat Book 10 at Page 56.
 2.) Deed of record is recorded in Instrument No. 2021E0134391, dated 12/09/2021 in the Recorder of Deeds Office, Jackson County, Missouri
 3.) Basis of bearings is established by the Missouri State Plane Coordinate System from GPS observation.

CERTIFICATION:
 I hereby certify that this drawing is based on an actual field survey made by me or under my direct supervision on the 28th day of July, 2023 and that said survey meets or exceeds the current Missouri Standards for Property Boundary Surveys, as established by the Missouri Board for Architects, Professional Engineers and Land Surveyors, and the Missouri Department of Natural Resources, Division of Geology and Land Survey.

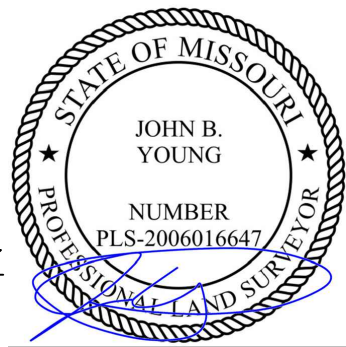

8-30-23
 Date

John B. Young PLS-2006016647

Location: S:\23.280 - 3825 Wyoming St\DRAWINGS\2023.08.15-BOUNDARY\23.280-BOU REVISED BOUNDARY.dwg-Aug 30, 2023-10:42am

J & J SURVEY LLC
 8680A N. GREEN HILLS ROAD • KANSAS CITY, MO 64154
 PHONE (816)741-1017 • FAX (816)741-1018

BOUNDARY SURVEY
 LOTS 6 THROUGH 10
 BONFILS HEIGHTS - BLOCK 4
 KANSAS CITY, JACKSON COUNTY,
 MISSOURI