

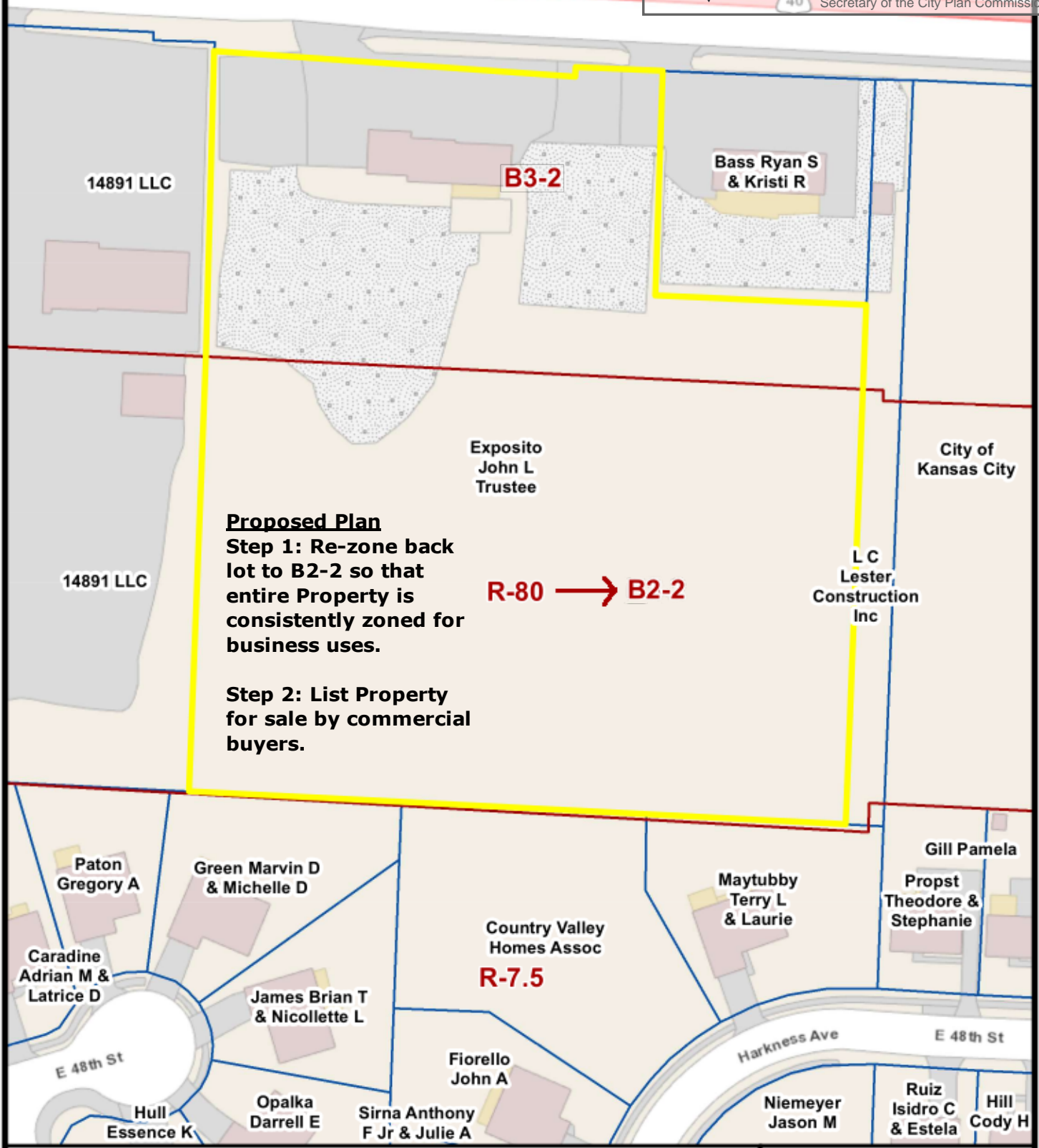

*Sara Copeland*  
Sara Copeland, AICP  
Secretary of the City Plan Commission

# 14901 E US 40 HWY



**Proposed Plan**  
Step 1: Re-zone back lot to B2-2 so that entire Property is consistently zoned for business uses.  
  
Step 2: List Property for sale by commercial buyers.

R-80 → B2-2

While the City of Kansas City, Missouri makes every effort to maintain and distribute accurate information, no warranties and/or representations of any kind are made regarding information, data or services provided. In no event shall the City of Kansas City, MO, be liable in any way to the users of this data. Users of this data shall hold the City of Kansas City, MO harmless in all matters and

